



# Homed:In

18 Station Road, Southwater, RH13 9HQ



Church Street

Rudgwick, Horsham, RH12 3ET

Offers Over £595,000

N DAYS OF MARKETING - MORE HOMES NI

SEARCH HOMEDIN



3



1



3





# Church Street



## Description

- UNDER OFFER - MORE LOCAL PROPERTIES REQUIRED
- Stunning and Secluded Gardens of 0.25 Acre
- Quiet Aspect from Rear
- Close Proximity to Shops, Doctors, Schools and More
- Book Your Viewing Today
- Bright and Well Presented Property
- VIDEO TOUR IN TAB
- Quiet Rear-facing Bedrooms
- Excellent Extension Potential









Floor Plan

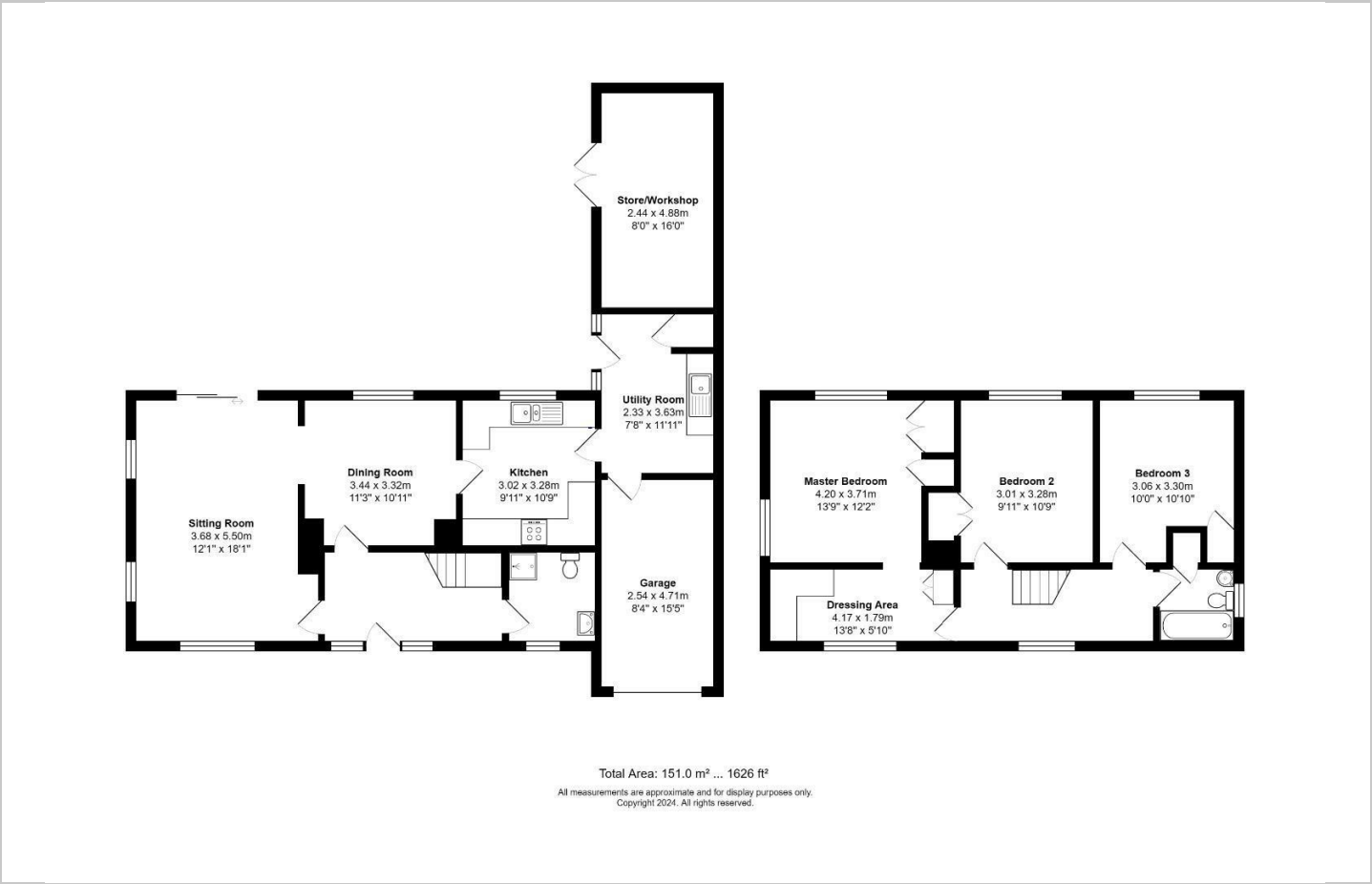

Area Map

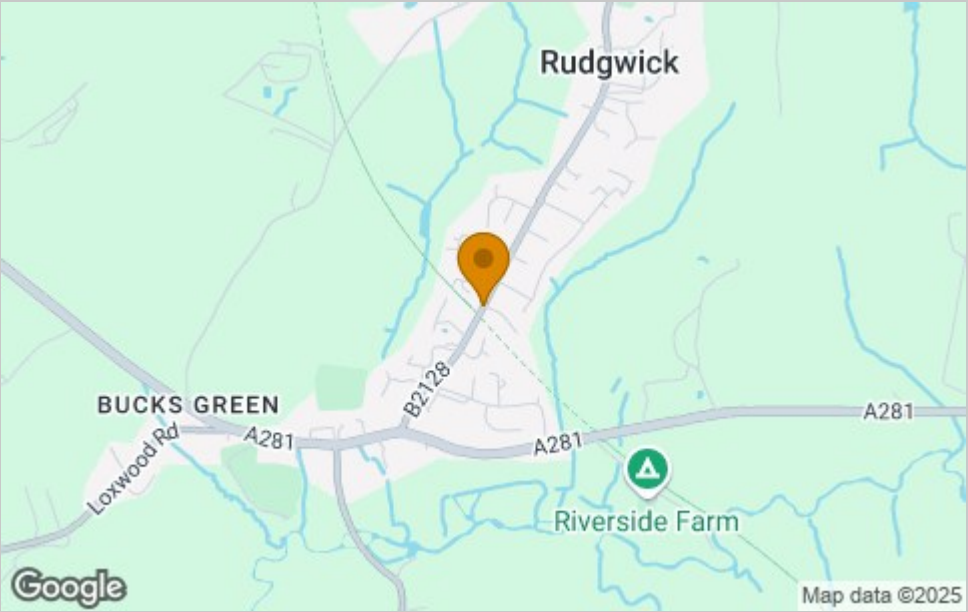

Viewing

Please contact our Horsham Office on 01403 597595 if you wish to arrange a viewing appointment for this property or require further information.

Energy Efficiency Graph

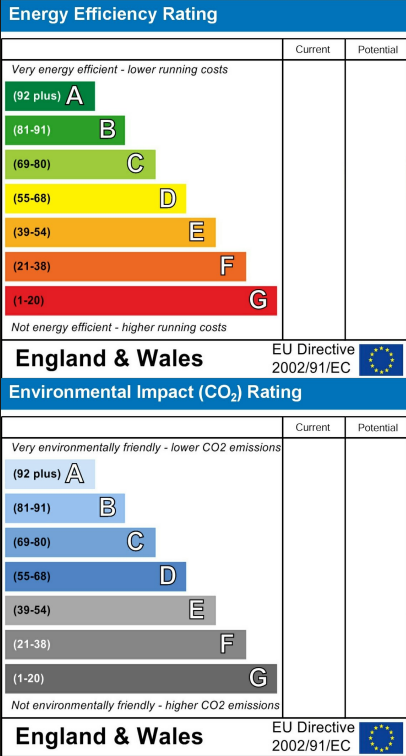

These particulars, whilst believed to be accurate are set out as a general outline only for guidance and do not constitute any part of an offer or contract. Intending purchasers should not rely on them as statements of representation of fact, but must satisfy themselves by inspection or otherwise as to their accuracy. No person in this firms employment has the authority to make or give any representation or warranty in respect of the property.

To **GET A FREE VALUATION** Call us on: **01403 597595**  
or email us at: **info@homedin.co.uk**